

AURISO

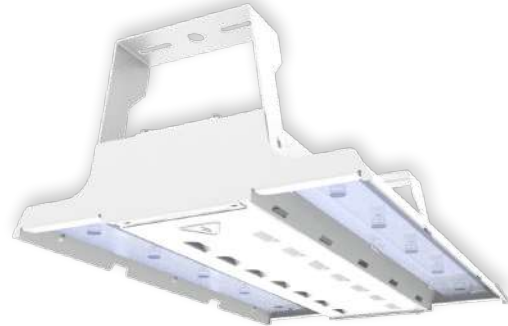

Auriso



Product information

The new Tungsram High Bay LED luminaire is an exceptional mixture of value and performance. The standard efficacy product range has been upgraded to reach up to 163 lm/w and cover lumen packages between 10,000 – 60,000 lumens in 5,000 steps. More combinations to choose from. The range includes no control and DALI versions and also several sensor options: SN (motion), RFM (daylight harvesting), RFS (can be controlled by the RFM). This solution is ideal for grouping luminaires. With the improved efficacy, wide range of control options and higher lumen output, the Auriso is an ideal choice to replace high watt HID and T5/T8 LFL fixtures in high bay and low bay applications, in industrial and commercial buildings.

Applications

- Designed to meet recommended luminance and illuminance requirements for High bay and Low bay applications

Finish

- Painted white finish with standard color: RAL 9016
- All existing RAL color is available for request

Application areas

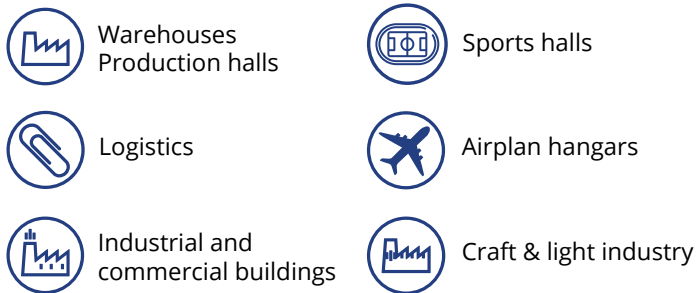

Mounting

- Y - cable or bracket mounting.
- For mounting options please see page 7.

Housing

- Aluminium housing
- Housing is available in two different sizes, defined by lumen packages
- IK10 protection level for Fix output and DALI versions
- IK08 for sensor types

LED & Optical Assembly

- IP50 protection level for the optical compartment for all lenses 35, 45, 65, 70 and 90 degree optics are dust protected.
- TU HB Series optical system enables LEDs to provide optimised illumination for open floor and racked aisles with photometric distributions of 35, 45, 65, 70, 80, 90, 100 and 110 degrees. Optics are designed for commercial & industrial applications where mounting height, fixture spacing & light levels help determine optical selection.
- A high performance product utilising top performing LED chips with three MacAdam steps, offering exceptional reliability.
- 3000K, 4000K & 5000K versions with 70 & 80 CRI.

Controls

- All DALI drivers use DALI1 protocol.
- Sensors working frequency is 5.8Ghz. Transmitting data on the same frequency band in close proximity to the installation of sensor products may cause potential interferences.
- SN(motion sensor) - enables standalone fixture control up to 15 m.
- RFM (Daylight harvesting) sensor in a local lighting control system grid without additional DALI wires, up to 15m installation height.
- RFS (on/off switch) enables group creation without daylight harvesting options. Only can be controlled by RFM.

Electrical

- 220-240V/50-60Hz
- System power factor is >0,95 and THD <15%
- All package includes pre-cable

Order Logic

Product ID	Module / Efficiency / Lumen	CCT / CRI	Optic	Control	Option	Precable	Color
TU High bay - Standard Efficiency							
AUR	1S10 - 1M Std 10klm 1S15 - 1M Std 15klm 1S20 - 1M Std 20klm 1S25 - 1M Std 25klm 1S30 - 1M Std 30klm 2S35 - 2M Std 35klm 2S40 - 2M Std 40klm 2S45 - 2M Std 45klm 2S50 - 2M Std 50klm 2S55 - 2M Std 55klm 2S60 - 2M Std 60klm	730 - 3000K CRI70 740 - 4000K CRI70 750 - 5000K CRI70 830 - 3000K CRI80 840 - 4000K CRI80 850 - 5000K CRI80	C1 - 110° Clear D1 - 100° Diffuse L3 - 35° L6 - 70° L9 - 90° U4 - 45° U6 - 65° U8 - 80°	FX - Fix output DL - DALI SN - Sensor (On / Off) RFM - RF Master RFS - RF Slave (On/Off)	ST - (non emergency)	PXX*	R7021NB XXXXXXX

* 1-10 m long precable is available
Module length is predefined by lumen package and not a selectable option.

Optical performance

Description		C1 Optics*																			
		Nominal lumen		730			740			750			830			840			850		
		lm	lm	w	lpw	lm	w	lpw	lm	w	lpw	lm	w	lpw	lm	w	lpw	lm	w	lpw	
Standard efficacy FX	AUR-1S10-***-FX-ST	10000	9900	64	161	10300	64	161	10300	64	167	9200	64	147	9500	64	147	9500	64	156	
	AUR-1S15-***-FX-ST	15000	14400	102	147	15000	102	147	15000	102	153	13300	102	134	13800	102	134	13800	102	143	
	AUR-1S20-***-FX-ST	20000	19200	132	151	19900	132	151	19900	132	157	17700	132	138	18400	132	138	18400	132	146	
	AUR-1S25-***-FX-ST	25000	24200	162	154	25000	162	154	25000	162	160	22300	162	141	23100	162	141	23100	162	150	
	AUR-1S30-***-FX-ST	30000	29100	202	150	30200	202	150	30200	202	155	26900	202	137	27900	202	137	27900	202	145	
	AUR-2S35-***-FX-ST	35000	33600	225	155	34800	225	155	34800	225	161	31000	225	141	32200	225	141	32200	225	150	
	AUR-2S40-***-FX-ST	40000	38700	272	147	40000	272	147	40000	272	153	35700	272	134	37000	272	134	37000	272	143	
	AUR-2S45-***-FX-ST	45000	43600	329	137	45100	329	137	45100	329	143	40200	329	125	41700	329	125	41700	329	133	
	AUR-2S50-***-FX-ST	50000	47900	329	151	49600	329	151	49600	329	157	44200	329	138	45900	329	138	45900	329	146	
	AUR-2S55-***-FX-ST	55000	53600	380	146	55500	380	146	55500	380	152	49500	380	133	51400	380	133	51400	380	142	
AUR-2S60-***-FX-ST	60000	56200	426	136	58100	426	136	58100	426	142	51800	426	124	53800	426	124	53800	426	132		
Standard efficacy DL	AUR-1S10-***-DL-ST	10000	9900	64	161	10300	64	161	10300	64	167	9200	64	147	9500	64	147	9500	64	156	
	AUR-1S15-***-DL-ST	15000	14400	102	147	15000	102	147	15000	102	153	13300	102	134	13800	102	134	13800	102	143	
	AUR-1S20-***-DL-ST	20000	19200	133	150	19900	133	150	19900	133	156	17700	133	137	18400	133	137	18400	133	145	
	AUR-1S25-***-DL-ST	25000	24200	163	153	25000	163	153	25000	163	160	22300	163	140	23100	163	140	23100	163	149	
	AUR-1S30-***-DL-ST	30000	29100	202	150	30200	202	150	30200	202	155	26900	202	137	27900	202	137	27900	202	145	
	AUR-2S35-***-DL-ST	35000	33600	226	154	34800	226	154	34800	226	160	31000	226	141	32200	226	141	32200	226	149	
	AUR-2S40-***-DL-ST	40000	38700	274	146	40000	274	146	40000	274	152	35700	274	133	37000	274	133	37000	274	142	
	AUR-2S45-***-DL-ST	45000	43600	331	136	45100	331	136	45100	331	142	40200	331	124	41700	331	124	41700	331	132	
	AUR-2S50-***-DL-ST	50000	47900	329	151	49600	329	151	49600	329	157	44200	329	138	45900	329	138	45900	329	146	
	AUR-2S55-***-DL-ST	55000	53600	383	145	55500	383	145	55500	383	151	49500	383	132	51400	383	132	51400	383	140	
AUR-2S60-***-DL-ST	60000	58100	427	141	60200	427	141	60200	427	146	53600	427	129	55700	427	129	55700	427	137		
Standard efficacy SN	AUR-1S10-***-SN-ST	10000	9900	65	158	10300	65	158	10300	65	165	9200	65	145	9500	65	145	9500	65	154	
	AUR-1S15-***-SN-ST	15000	14400	104	144	15000	104	144	15000	104	150	13300	104	132	13800	104	132	13800	104	140	
	AUR-1S20-***-SN-ST	20000	19200	133	150	19900	133	150	19900	133	156	17700	133	137	18400	133	137	18400	133	145	
	AUR-1S25-***-SN-ST	25000	24200	164	152	25000	164	152	25000	164	159	22300	164	139	23100	164	139	23100	164	148	
	AUR-1S30-***-SN-ST	30000	29100	203	149	30200	203	149	30200	203	155	26900	203	136	27900	203	136	27900	203	144	
	AUR-2S35-***-SN-ST	35000	33600	226	154	34800	226	154	34800	226	160	31000	226	141	32200	226	141	32200	226	149	
	AUR-2S40-***-SN-ST	40000	38700	274	146	40000	274	146	40000	274	152	35700	274	133	37000	274	133	37000	274	142	
	AUR-2S45-***-SN-ST	45000	43600	331	136	45100	331	136	45100	331	142	40200	331	124	41700	331	124	41700	331	132	
	AUR-2S50-***-SN-ST	50000	47900	331	150	49600	331	150	49600	331	156	44200	331	137	45900	331	137	45900	331	145	
	AUR-2S55-***-SN-ST	55000	53600	382	145	55500	382	145	55500	382	151	49500	382	132	51400	382	132	51400	382	141	
AUR-2S60-***-SN-ST	60000	56200	427	136	58100	427	136	58100	427	141	51800	427	124	53800	427	124	53800	427	132		
Standard efficacy RFS	AUR-1S10-***-SN-ST	10000	9900	65	158	10300	65	158	10300	65	165	9200	65	145	9500	65	145	9500	65	154	
	AUR-1S15-***-SN-ST	15000	14400	104	144	15000	104	144	15000	104	150	13300	104	132	13800	104	132	13800	104	140	
	AUR-1S20-***-SN-ST	20000	19200	133	150	19900	133	150	19900	133	156	17700	133	137	18400	133	137	18400	133	145	
	AUR-1S25-***-SN-ST	25000	24200	164	152	25000	164	152	25000	164	159	22300	164	139	23100	164	139	23100	164	148	
	AUR-1S30-***-SN-ST	30000	29100	203	149	30200	203	149	30200	203	155	26900	203	136	27900	203	136	27900	203	144	
	AUR-2S35-***-SN-ST	35000	33600	226	154	34800	226	154	34800	226	160	31000	226	141	32200	226	141	32200	226	149	
	AUR-2S40-***-SN-ST	40000	38700	274	146	40000	274	146	40000	274	152	35700	274	133	37000	274	133	37000	274	142	
	AUR-2S45-***-SN-ST	45000	43600	331	136	45100	331	136	45100	331	142	40200	331	124	41700	331	124	41700	331	132	
	AUR-2S50-***-SN-ST	50000	47900	331	150	49600	331	150	49600	331	156	44200	331	137	45900	331	137	45900	331	145	
	AUR-2S55-***-SN-ST	55000	53600	382	145	55500	382	145	55500	382	151	49500	382	132	51400	382	132	51400	382	141	
AUR-2S60-***-SN-ST	60000	56200	427	136	58100	427	136	58100	427	141	51800	427	124	53800	427	124	53800	427	132		
Standard efficacy RFM	AUR-1S10-***-RFM-ST	10000	9900	64	161	10300	64	161	10300	64	167	9200	64	147	9500	64	147	9500	64	156	
	AUR-1S15-***-RFM-ST	15000	14400	103	146	15000	103	146	15000	103	151	13300	103	133	13800	103	133	13800	103	142	
	AUR-1S20-***-RFM-ST	20000	19200	132	151	19900	132	151	19900	132	157	17700	132	138	18400	132	138	18400	132	146	
	AUR-1S25-***-RFM-ST	25000	24200	163	153	25000	163	153	25000	163	160	22300	163	140	23100	163	140	23100	163	149	
	AUR-1S30-***-RFM-ST	30000	29100	202	150	30200	202	150	30200	202	155	26900	202	137	27900	202	137	27900	202	145	
	AUR-2S35-***-RFM-ST	35000	33600	225	155	34800	225	155	34800	225	161	31000	225	141	32200	225	141	32200	225	150	
	AUR-2S40-***-RFM-ST	40000	38700	273	147	40000	273	147	40000	273	152	35700	273	134	37000	273	134	37000	273	142	
	AUR-2S45-***-RFM-ST	45000	43600	330	137	45100	330	137	45100	330	142	40200	330	125	41700	330	125	41700	330	132	
	AUR-2S50-***-RFM-ST	50000	47900	330	150	49600	330	150	49600	330	156	44200	330	137	45900	330	137	45900	330	146	
	AUR-2S55-***-RFM-ST	55000	53600	381	146	55500	381	146	55500	381	151	49500	381	133	51400	381	133	51400	381	141	
AUR-2S60-***-RFM-ST	60000	58100	426	136	60200	426	136	60200	426	142	53600	426	124	55700	426	124	55700	426	132		

*all lumen values have been measured with C1 optics, in any other case please use the optical multipliers to determine the lumen value. Power consumption will remain the same.

Optical multipliers

Optics	Multiplier	Optics	Multiplier
C1	100%	U4	85%
D1	90%	L6	99%
U8	89%	U6	82%
L3	105%	L9	103%

	Description	Nominal lumen lm	Input current A	T ambient		L80B50 Ta25C	L90B10 Ta25C
				Min. °C	Max. °C		
Standard efficacy FX	AUR-1S10-***-FX-ST	10000	0,35	-25	50	292000	126000
	AUR-1S15-***-FX-ST	15000	0,56	-25	50	142000	62000
	AUR-1S20-***-FX-ST	20000	0,72	-25	50	124000	54000
	AUR-1S25-***-FX-ST	25000	0,88	-25	50	196000	82000
	AUR-1S30-***-FX-ST	30000	1,10	-25	45	140000	58000
	AUR-2S35-***-FX-ST	35000	1,23	-25	50	114000	50000
	AUR-2S40-***-FX-ST	40000	1,48	-25	50	114000	50000
	AUR-2S45-***-FX-ST	45000	1,79	-25	50	109000	48000
	AUR-2S50-***-FX-ST	50000	1,79	-25	50	182000	74000
	AUR-2S55-***-FX-ST	55000	2,07	-25	45	173000	71000
AUR-2S60-***-FX-ST	60000	2,32	-25	45	163000	67000	
Standard efficacy DL	AUR-1S10-***-DL-ST	10000	0,35	-25	50	282000	126000
	AUR-1S15-***-DL-ST	15000	0,56	-25	50	146000	64000
	AUR-1S20-***-DL-ST	20000	0,73	-25	50	124000	54000
	AUR-1S25-***-DL-ST	25000	0,89	-25	50	182000	74000
	AUR-1S30-***-DL-ST	30000	1,10	-25	45	134000	56000
	AUR-2S35-***-DL-ST	35000	1,23	-25	50	111000	48000
	AUR-2S40-***-DL-ST	40000	1,49	-25	50	111000	48000
	AUR-2S45-***-DL-ST	45000	1,81	-25	50	108000	47000
	AUR-2S50-***-DL-ST	50000	1,79	-25	50	196000	82000
	AUR-2S55-***-DL-ST	55000	2,09	-25	45	164000	68000
AUR-2S60-***-DL-ST	60000	2,33	-25	45	134000	57000	
Standard efficacy SN	AUR-1S10-***-SN-ST	10000	0,35	-25	50	292000	126000
	AUR-1S15-***-SN-ST	15000	0,57	-25	50	142000	62000
	AUR-1S20-***-SN-ST	20000	0,73	-25	50	124000	54000
	AUR-1S25-***-SN-ST	25000	0,89	-25	50	196000	82000
	AUR-1S30-***-SN-ST	30000	1,11	-25	45	140000	58000
	AUR-2S35-***-SN-ST	35000	1,23	-25	50	114000	50000
	AUR-2S40-***-SN-ST	40000	1,49	-25	50	114000	50000
	AUR-2S45-***-SN-ST	45000	1,81	-25	50	109000	48000
	AUR-2S50-***-SN-ST	50000	1,81	-25	50	182000	74000
	AUR-2S55-***-SN-ST	55000	2,08	-25	45	173000	71000
AUR-2S60-***-SN-ST	60000	2,33	-25	45	163000	67000	
Standard efficacy RFS	AUR-1S10-***-SN-ST	10000	0,35	-25	50	292000	126000
	AUR-1S15-***-SN-ST	15000	0,57	-25	50	142000	62000
	AUR-1S20-***-SN-ST	20000	0,73	-25	50	124000	54000
	AUR-1S25-***-SN-ST	25000	0,89	-25	50	196000	82000
	AUR-1S30-***-SN-ST	30000	1,11	-25	45	140000	58000
	AUR-2S35-***-SN-ST	35000	1,23	-25	50	114000	50000
	AUR-2S40-***-SN-ST	40000	1,49	-25	50	114000	50000
	AUR-2S45-***-SN-ST	45000	1,81	-25	50	109000	48000
	AUR-2S50-***-SN-ST	50000	1,81	-25	50	182000	74000
	AUR-2S55-***-SN-ST	55000	2,08	-25	45	173000	71000
AUR-2S60-***-SN-ST	60000	2,33	-25	45	163000	67000	
Standard efficacy RFM	AUR-1S10-***-RFM-ST	10000	0,35	-25	50	282000	126000
	AUR-1S15-***-RFM-ST	15000	0,56	-25	50	146000	64000
	AUR-1S20-***-RFM-ST	20000	0,72	-25	50	124000	54000
	AUR-1S25-***-RFM-ST	25000	0,89	-25	50	182000	74000
	AUR-1S30-***-RFM-ST	30000	1,10	-25	45	134000	56000
	AUR-2S35-***-RFM-ST	35000	1,23	-25	50	111000	48000
	AUR-2S40-***-RFM-ST	40000	1,49	-25	50	111000	48000
	AUR-2S45-***-RFM-ST	45000	1,80	-25	50	108000	47000
	AUR-2S50-***-RFM-ST	50000	1,80	-25	50	196000	82000
	AUR-2S55-***-RFM-ST	55000	2,08	-25	45	164000	68000
AUR-2S60-***-RFM-ST	60000	2,32	-25	45	134000	57000	

DALI address

Description	DALI address required / luminaire
AUR-1S10 *** ** DL-ST	1
AUR-1S15 *** ** DL-ST	1
AUR-1S20 *** ** DL-ST	1
AUR-1S25 *** ** DL-ST	2
AUR-1S30 *** ** DL-ST	2
AUR-2S35 *** ** DL-ST	2
AUR-2S40 *** ** DL-ST	2
AUR-2S45 *** ** DL-ST	4
AUR-2S50 *** ** DL-ST	4
AUR-2S55 *** ** DL-ST	4
AUR-2S60 *** ** DL-ST	4

IP rating of optical space

Lens	Angle	IP rating
L3	35°	IP50
L6	70°	IP50
L9	90°	IP50
C1	110°	IP20
D1	100°	IP20
U4	45°	IP50
U6	65°	IP50
U8	80°	IP20

Photometric distributions

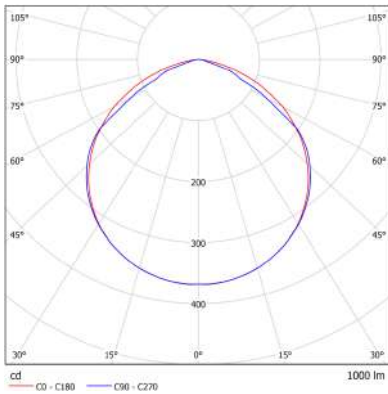

C1 - 110° Clear

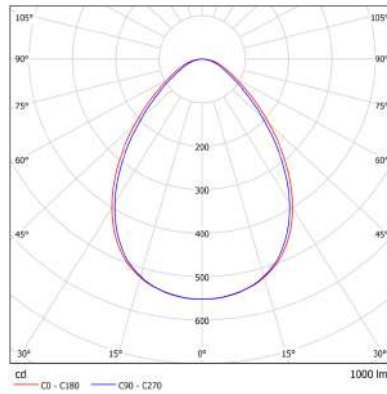

U8 - 80°

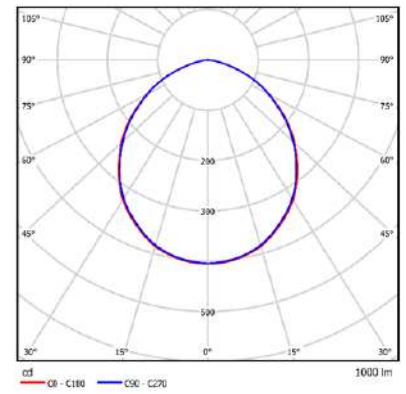

D1 - 100° Diffuse

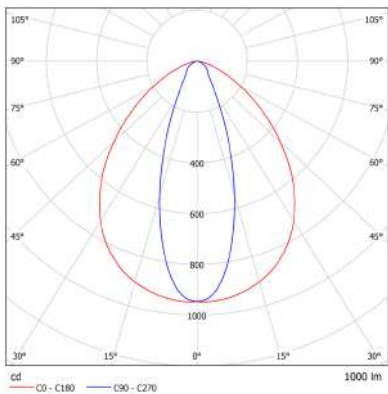

L3 - 35°

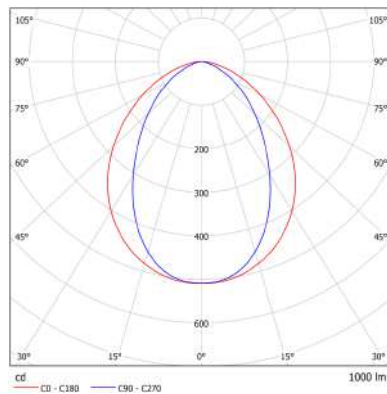

L6 - 70°

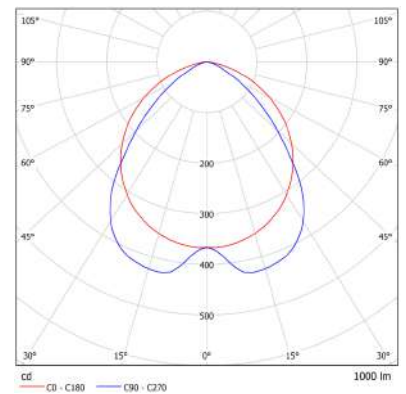

L9 - 90°

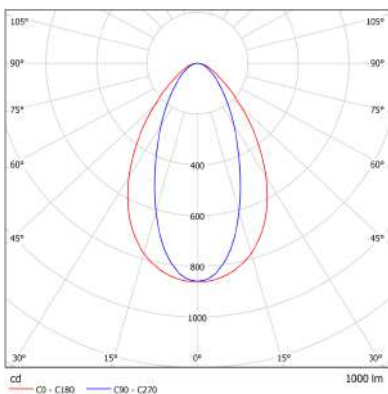

U4 - 45°

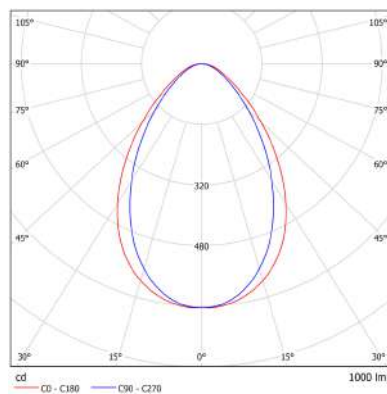

U6 - 65°

UGR value

Values depending on lumen package and installation details.

	Standard efficiency**
C1	24-28
D1	24-28
L3	16-20
L6	20-25
L9	22-26
U4	19-24
U6	20-24
U8	21-25

**4H/8H, 70-50-20 reflection

Mounting & Accessories

Mounting Options

Image

Accessories

Rod Mount (optional)

Available on all fixture configurations. Attaches to M10 threaded rod (rod and nuts not included).

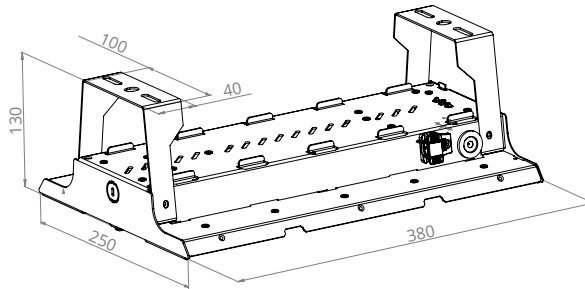

TU HB Bracket kit **93108564**
2 pcs / kit

TUHB Bracket kit **93116762**
20 pcs / 10 kits

Y-Cable w/hook (optional)

Use with Standard Mounting Option only. Order separately. Sold per pair - suitable for one fixture 1.5 m, 3 m, 4.5 m, 6 m lengths available.

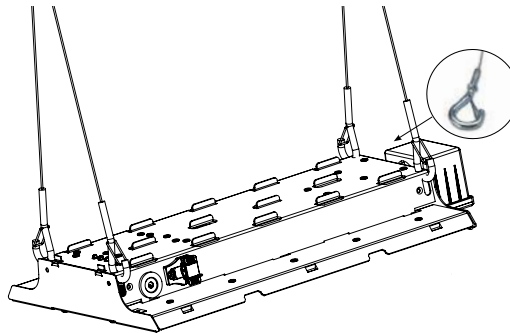

93118332
1500MM Y-CABLE HOOK PAIR
FOR HIGH BAY 52

93118333
3000MM Y-CABLE HOOK PAIR
FOR HIGH BAY 52

93118334
4500MM Y-CABLE HOOK PAIR
FOR HIGH BAY 52

93118335
6000MM Y-CABLE HOOK PAIR
FOR HIGH BAY 52

Tilted bracket kit (optional)

Available on all fixture configurations. Kit needs to be ordered separately. The angle is adjustable from 0° - 45° in 5° steps.

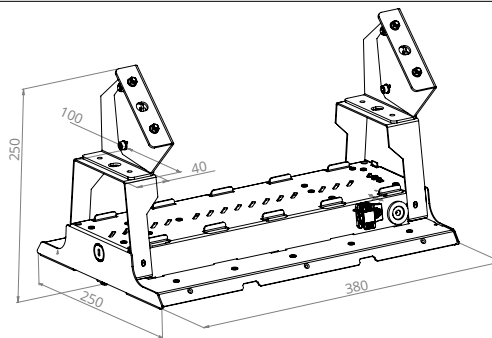

93104725
Using tilted brackets - 2 pcs / kit - the Rod Mount TUHB bracket kit has to be ordered as well.

Busbar bracket kit (optional)

Available on all fixture configurations. Kit needs to be ordered separately.

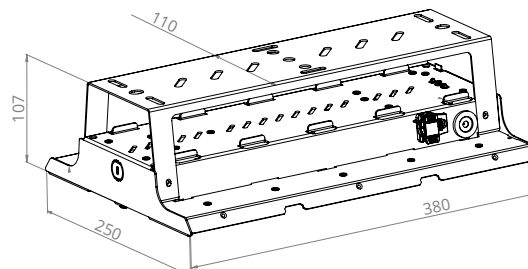

93116910
TU HB lighting busbar bracket kit - single pack

93116861
TU HB lighting busbar bracket kit - 5 pack

Dimensions (mm)

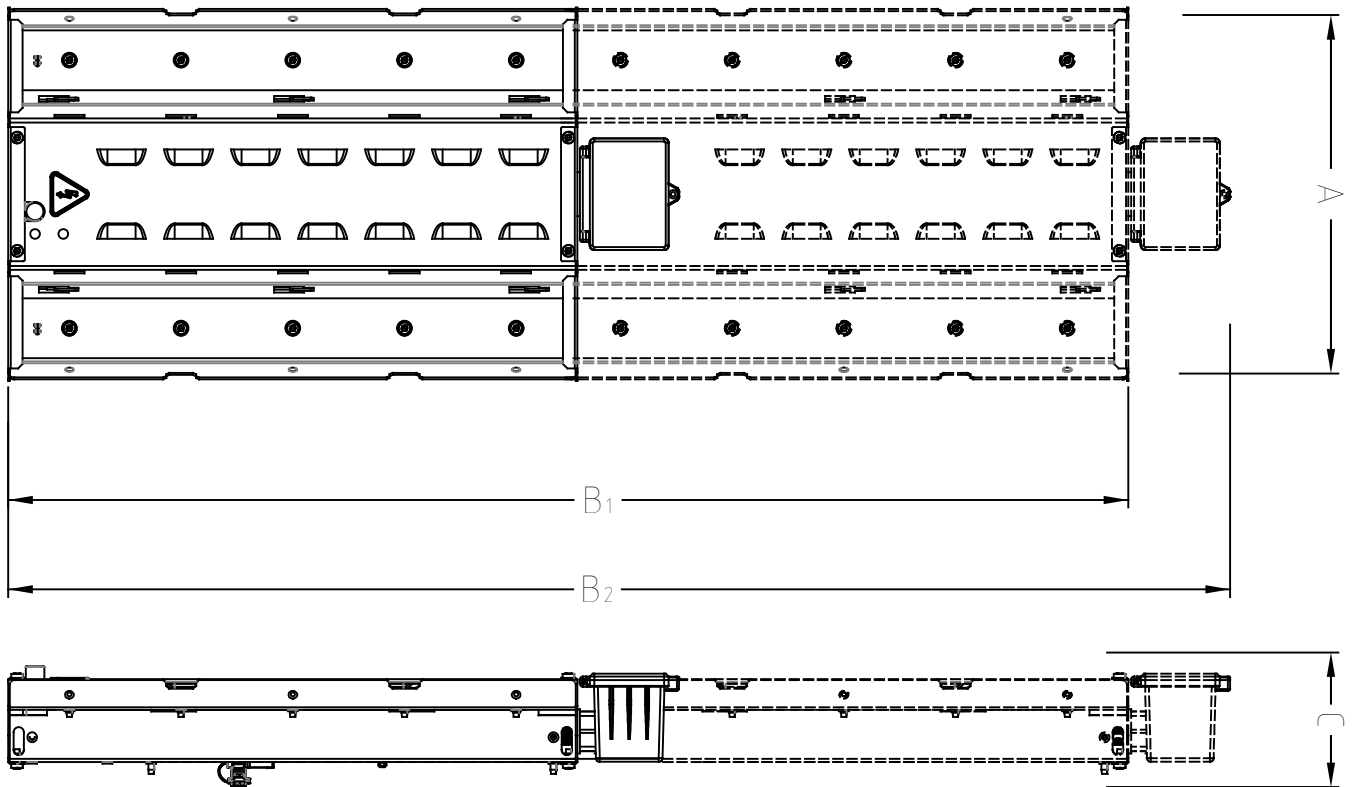

	10-30	35-60	kLM
	250		A
FX • DL • RFS	382	752	B ¹
SN • RFM	450	820	B ²
FX • DL • SN • RFM	75		C
RFS	80		

Weight (kg)

	10-30	35-60
FX . DL	1,3	2,4
SN . RFM	1,4	2,4
RFS	1,4	2,5